

**SVEN**®  
YOU WANT – WE CAN

2.1 Multimedia Speaker System

## OPERATION MANUAL



**MS-308**

[www.sven.fi](http://www.sven.fi)

***Congratulations on your purchase of the Sven speaker system!***

**COPYRIGHT**

© 2014. SVEN PTE. LTD. Version 1.0 (V 1.0).

This Manual and information contained in it are copyrighted. All rights reserved.

**TRADEMARKS**

All trademarks are the property of their legal holders.

**NOTICE OF RESPONSIBILITY RESTRICTION**

Despite the exerted efforts to make this Manual more exact, some discrepancies may occur. The information in this Manual is given on «as is» terms. The author and the publisher do not bear any liability to a person or an organization for loss or damage which has arisen from the information contained in this Manual.

**CONTENTS**

|   |          |
|---|----------|
| <b>1. BUYER RECOMMENDATIONS .....</b>     | <b>2</b> |
| <b>2. PACKAGE CONTENTS .....</b>          | <b>3</b> |
| <b>3. SAFETY PRECAUTIONS .....</b>        | <b>3</b> |
| <b>4. TECHNICAL DESCRIPTION .....</b>     | <b>3</b> |
| <b>5. PREPARATION AND OPERATION .....</b> | <b>4</b> |
| <b>6. TROUBLESHOOTING .....</b>           | <b>5</b> |
| <b>7. TECHNICAL SPECIFICATIONS .....</b>  | <b>5</b> |

**1. BUYER RECOMMENDATIONS**

- Unpack the device carefully. Make sure there are no accessories left in the box. Check up the device for damage; if the product was damaged during transportation, address the firm which carried out the delivery; if the product functions incorrectly, address the dealer at once.
- Check up the package contents and availability of the warranty card. Make sure the warranty card has a shop stamp, a legible signature or the seller’s stamp and purchase date, and the goods number corresponds to that in the warranty card.
- Do not switch on the speaker system immediately after you bring it into a room from environment with negative temperature! After unpacking, the speaker system should be kept in conditions of room temperature for at least 4 hours.
- Before installing and using the speaker system, read this Manual carefully and keep it for future reference.

*Technical support is on [www.sven.fi](http://www.sven.fi)*

## 2. PACKAGE CONTENTS

- Subwoofer — 1 pc
- Satellites — 2 pcs
- Wired remote control — 1 pc
- Mini-jack to mini-jack signal cable — 1 pc
- Operation manual — 1 pc
- Warranty card — 1 pc

## 3. SAFETY PRECAUTIONS



**Caution! High voltage inside! To avoid the risk of electric shock do not open or touch elements inside.**

- To avoid electric shock, do not open the MSS and do not perform repairs by yourself. Service and repairs should be performed only by qualified specialists in an authorized service center. The list of authorized service centers is available on [www.sven.fi](http://www.sven.fi)
- Do not allow the circuit of wires (including the grounded ones) between the speakers, on the power amplifier or the ground, for it causes damage to the power amplifier output stage.
- Do not touch the MSS power cord plug pins for 2 seconds after unplugging it from the mains.
- Do not put foreign objects inside the holes of the MSS.
- Protect the MSS from high humidity, water and dust.
- Protect the MSS from heating: do not place it closer than 1 m from a heat source. Do not expose it to direct sunlight.
- Do not place any open flame sources on or close to MSS.
- Do not place the MSS in poorly ventilated areas. Leave an air gap of 10 cm or more. When operating the MSS, do not put any devices on it, do not cover it with cloth or other objects preventing it from cooling.
- Do not use any chemical agents for cleaning. Clean it with dry soft cloth only.

## 4. TECHNICAL DESCRIPTION

The device is designed for playing music, sounding videogames, movies, etc. Can be used with a PC, CD/DVD player and other audio devices.

### Special features

- Wired remote control (RC)
- Control knobs on the subwoofer side panel
- Master volume control
- Independent volume control of the subwoofer
- Jacks for headphones and microphone connection on the wire RC

### Side panel / wired remote control

- ① VOL: volume control knob
- ② BASS: bass control knob
- ③ Stereo input
- ④ Satellite output
- ⑤ POWER: switch for turn on/off the power
- ⑥ Power cord

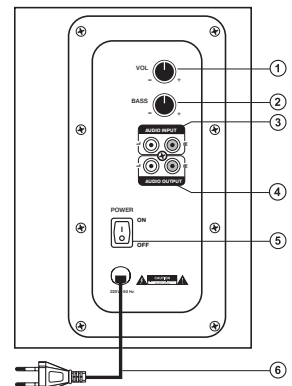

Fig. 1. Side panel

2.1 Multimedia Speaker System

- ⑦ Input on the wired RC
- ⑧ Headphone input
- ⑨ Microphone input
- ⑩ Signal cable
- ⑪ Microphone cable (black)
- ⑫ Volume control knob

**5. PREPARATION AND OPERATION**

**Speaker placement**

- Place the satellites symmetrically to the listener at the distance not less than one meter.
- Place MSS far away from monitors and TV sets, as insignificant image distortion in these super-sensitive devices is possible. We recommend that the subwoofer should be placed on the table.

**Installation and operation guide**

**Warning! All components should be switched off before connection.**

- Connect mini-jack of the wired RC to PC sound input second mini-jack to the microphone input.
- Connect two RCA-jacks the AUDIO INPUTS of the subwoofer. Insert mini-jack of the signal cable to the input on the wired RC.
- Plug power cord to the power socket.
- Adjust volume control knobs to be minimal position and switch on the power button on the subwoofer.
- Adjust the volume and bass level.

**You can also connect any sound source (MP3 etc.) with mini-jack output to your sound system. You can connect mini-jack of the signal cable directly to your sound source (PC etc.) without wired RC. Also, you can connect headphones and microphone (headset) to your wired RC.**

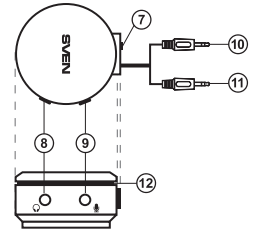

Fig. 2. Wired Remote Control

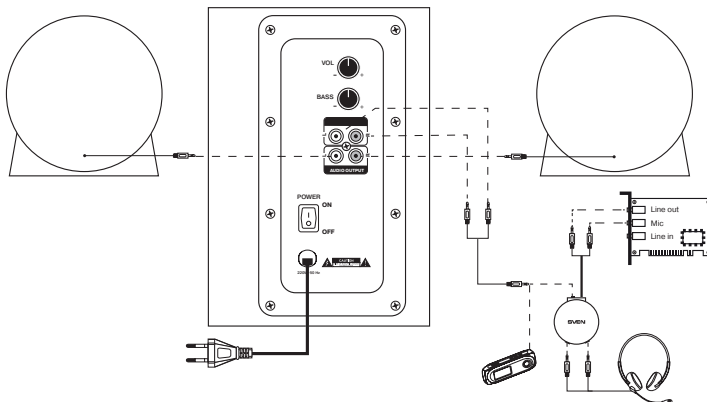

Fig. 3. Connection diagram

## 6. TROUBLESHOOTING

| Problem                               | Cause   | Solution                                    |
|---------------------------------------|---|---|
| The MSS doesn't turn on.              | The MSS is not connected to the mains outlet. | Check the connection.                       |
|                                       | Power switch is off.                          | Turn on the switch.                         |
| No sound.                             | Volume level is set at minimum value.         | Adjust the volume control knob.             |
|                                       | Improperly connected audio source.            | Connect audio sources correctly.            |
| There is too quiet sound of speakers. | Volume level is set at minimum value.         | Adjust the volume control knob.             |
| Distortion of sound.                  | Large amplitude of the input signal.          | Turn down the source volume and MSS volume. |

If none of the above methods can solve the problem, please seek professional advice at your nearest service center. Never attempt to repair the product yourself.

## 7. TECHNICAL SPECIFICATIONS

| Parameter, measurement unit                             | Value                             |
|---|-----------------------------------|
| Output power (RMS), W<br>subwoofer<br>satellites        | 35 (13 + 2 × 11)<br>13<br>2 × 11  |
| Speaker diameters, mm<br>subwoofer<br>satellites        | ∅ 100<br>∅ 100                    |
| Voltage supply, V/Hz                                    | ~220/50                           |
| Frequency range, Hz<br>subwoofer<br>satellites          | 50 – 200<br>200 – 20 000          |
| Dimensions (one speaker), mm<br>subwoofer<br>satellites | 190 × 210 × 210<br>128 × 127 × 89 |
| Weight, kg  | 2.6                               |

**Notes:**

- **Technical specifications given in this table are supplemental information and cannot give occasion to claims.**
- **Technical specifications and package contents are subject to change without notice due to the improvement of SVEN production.**

## 2.1 Multimedia Speaker System

**SVEN**®  
YOU WANT – WE CAN



Модель: **MS-308**

Импортер в России: ООО «СКАНДИТРЕЛ»,  
111024, РФ, г. Москва, ул. Авиамоторная, д. 65, стр. 1.  
Уполномоченная организация в России: ООО «РТ-Ф»,  
105082, г. Москва, ул. Фридриха Энгельса, д. 75, стр. 5.  
Условия гарантийного обслуживания смотрите  
в гарантийном талоне или на сайте **www.sven.fi**  
Гарантийный срок: 12 мес. Срок службы: 5 лет.  
Производитель: «СВЕН ПТЕ. Лимитед», 176  
Джу Чиат Роуд, № 02-02, Сингапур, 427447.  
Произведено под контролем «Свен Скандинавия  
Лимитед», 48310, Финляндия, Котка, Котолахдентие, 15.  
Сделано в Китае.

Manufacturer: SVEN PTE. LTD, 176 Joo Chiat Road,  
№ 02-02, Singapore, 427447. Produced under the control  
of Oy Sven Scandinavia Ltd. 15, Kotolahdentie, Kotka,  
Finland, 48310. Made in China.

® Registered Trademark of Oy SVEN  
Scandinavia Ltd. Finland.

**MS-308**