

SVEN®
YOU WANT – WE CAN

2.1 Multimedia Speaker
System with Bluetooth

OPERATION MANUAL



MS – 350BL

www.sven.fi

Congratulations on your purchase of the Sven speaker system!**COPYRIGHT**

© 2014. SVEN PTE. LTD. Version 1.0 (V 1.0).

This Manual and information contained in it are copyrighted. All rights reserved.

TRADEMARKS

All trademarks are the property of their legal holders.

NOTICE OF RESPONSIBILITY RESTRICTION

Despite the exerted efforts to make this Manual more exact, some discrepancies may occur. The information in this Manual is given on «as is» terms. The author and the publisher do not bear any liability to a person or an organization for loss or damage which has arisen from the information contained in this Manual.

CONTENTS

1. BUYER RECOMMENDATIONS	1
2. PACKAGE CONTENTS	2
3. SAFETY PRECAUTIONS	2
4. TECHNICAL DESCRIPTION	2
5. PREPARATION AND OPERATION	4
6. TROUBLESHOOTING	7
7. TECHNICAL SPECIFICATIONS	7

1. BUYER RECOMMENDATIONS

- Unpack the device carefully. Make sure there are no accessories left in the box. Check up the device for damage; if the product was damaged during transportation, address the firm which carried out the delivery; if the product functions incorrectly, address the dealer at once.
- Check up the package contents and availability of the warranty card. Make sure the warranty card has a shop stamp, a legible signature or the seller's stamp and purchase date, and the goods number corresponds to that in the warranty card.
- Do not switch on the speaker system immediately after you bring it into a room from environment with negative temperature! After unpacking, the speaker system should be kept in conditions of room temperature for at least 4 hours.
- Before installing and using the speaker system, read this Manual carefully and keep it for future reference.

Technical support is on www.sven.fi.

2. PACKAGE CONTENTS

- Subwoofer – 1 pc
- Satellites – 2 pcs
- Remote control – 1 pc
- CR2025 battery installed into the remote control – 1 pc
- Operation manual – 1 pc
- Warranty card – 1 pc

3. SAFETY PRECAUTIONS



Caution! High voltage inside! To avoid the risk of electric shock do not open or touch elements inside.

- To avoid electric shock, do not open the MSS and do not perform repairs by yourself. Service and repairs should be performed only by qualified specialists in an authorized service center. The list of authorized service centers is available on www.sven.fi
- Do not allow the circuit of wires (including the grounded ones) between the speakers, on the power amplifier or the ground, for it causes damage to the power amplifier output stage.
- Do not touch the MSS power cord plug pins for 2 seconds after unplugging it from the mains.
- Disconnect the MSS from the mains system during a fuse replacement. Use fuses of the same type and rated value. Do not use hand-made fuses.
- Do not put foreign objects inside the holes of the MSS.
- Protect the MSS from high humidity, water and dust.
- Protect the MSS from heating: do not place it closer than 1 m from a heat source. Do not expose it to direct sunlight.
- Do not place any open flame sources on or close to MSS.
- Do not place the MSS in poorly ventilated areas. Leave an air gap of 10 cm or more. When operating the MSS, do not put any devices on it, do not cover it with cloth or other objects preventing it from cooling.
- Do not use any chemical agents for cleaning. Clean it with dry soft cloth only.

4. TECHNICAL DESCRIPTION

MS-350BL 2.1 Multimedia Speaker System (MSS) with Bluetooth is designed to play music and sound games, movies, etc. The MSS has a built-in power amplifier, a signal and an audio cable allowing to connect it to virtually any audio source (CD/MP3-player, PC, etc.) without using an additional power amplifier. The MSS has a built-in Bluetooth device. Remote control is included.



Special features

- Speaker system is compatible with PCs, DVD/Media-players, mobile devices and other sound sources
- Built-in Bluetooth device
- LED digital display
- Headphone and microphone jacks
- Remote control
- Magnetic shielding
- Wooden (MDF) subwoofer cabinet

Operation Manual

MS-350BL

Front and rear subwoofer panels

- ① Digital LED display
- ② VOLUME +/-: MSS switch-on (pressed short in the ST-BY mode); volume up/down (pressed short in the operation mode); AUX/BT audio source selection (both buttons pressed at once in the operation mode)
- ③ ON/OFF: power switch
- ④ Power cord
- ⑤ OUTPUT: satellite output jack
- ⑥ : microphone jack (when PC-connected)
- ⑦ : headphone jack (operates only if an AUX audio source is on)
- ⑧ Audio source (PC microphone input etc.) connection cable

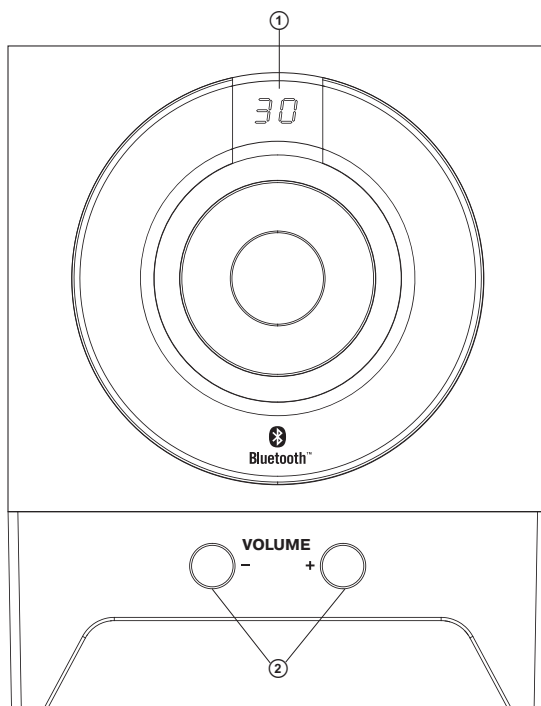

Fig. 1. Subwoofer control panel

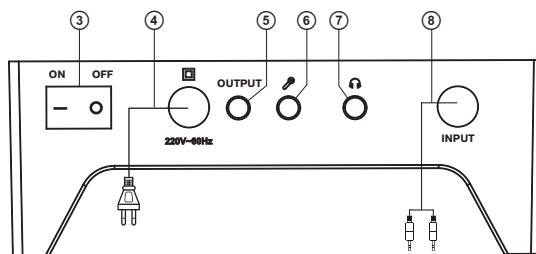

Fig. 2. Subwoofer rear panel

2.1 Multimedia Speaker System with Bluetooth

Remote control

- ① : On/Off button
- ② : Bluetooth activation button
- ③ VOL+/-: volume up/down
- ④ AUX: AUX stereo input selection
- ⑤ : sound on/off
- ⑥ : previous track (in the Bluetooth mode)
- ⑦ : next track (in the Bluetooth mode)
- ⑧ : play/pause (in the Bluetooth mode)
- ⑨ TRE.+/-: treble level up/down
- ⑩ BASS+/-: bass level up/down

Notes:

- **Before operating the remote control, extract the battery, remove the film protecting the battery from discharge during transportation, and insert the battery back into the remote control.**
- **Use the remote control at an angle of no more than 30°, no more than 7 meters away.**
- **Direct the remote control at the IR receiver display on the subwoofer.**
- **If the remote control does not work, check the battery or replace the discharged battery with a new one.**
- **Remove the battery from the remote control if you don't intend to use it for a long time (more than a week).**

5. PREPARATION AND OPERATION

Speaker placement

- Place the speakers symmetrically to the listener at least one meter away. The subwoofer emits non-directional sound, therefore it can be located in any place of the room where it sounds the best.
- Place MSS far away from monitors and TV sets, as insignificant image distortion in these supersensitive devices is possible.

MSS connecting and control

MS-350BL speaker system can be connected to virtually any audio devices: MP3/CD players, PCs, laptops, etc. (see connection diagram in Fig. 4).

- Before making any connections, make sure the MSS is off and unplugged. Then connect the subwoofer OUTPUT ⑤ jack to the satellites using the built-in audio cables.
- To connect the MSS to a PC, MP3/CD player or a telephone, use the signal cable ⑧ built into the subwoofer. Insert the mini-jack of the signal cable (green) into the line-out port of your PC sound card or your MP3/CD player, and the mini-jack of the microphone cable (pink) – into the mic input port of your sound card, as shown in Fig. 4.
- Connect the subwoofer to the mains outlet with the power cord ④.
- Turn on the subwoofer power supply using the ON/OFF switch (③, ON position) on the subwoofer rear panel.

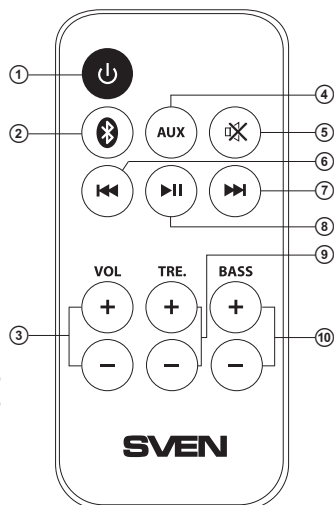

Fig. 3. Remote control

Operation Manual

MS-350BL

- Turn on the MSS with the VOLUME+ button ② on the front panel or the on/off button ① on the remote control.
- Select a signal source by simultaneously pressing the «-» and «+» ② buttons on the subwoofer front panel or the remote control buttons ② and ④. The LED display ① will show BL/AU for a short moment.
- Adjust the master volume as desired with the VOLUME+/- ② buttons on the front panel or with the VOLUME+/- ③ buttons on the RC.

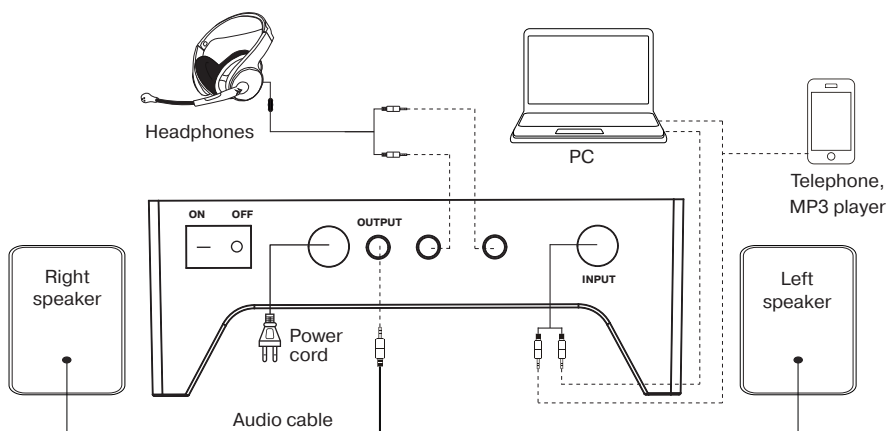

Fig. 4. Connection diagram

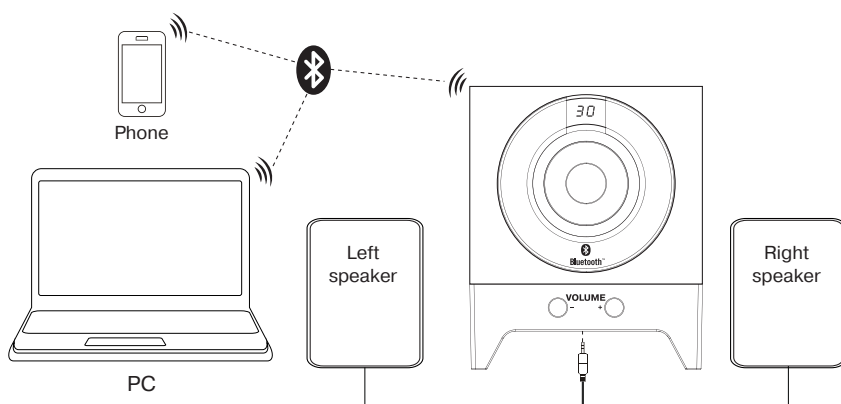

Fig. 5. Bluetooth device connection diagram

- Adjust the bass and treble level using the TRE.+/- ⑨ and BASS+/- ⑩ buttons on the RC.
- To use headphones, connect them to the headphone jack ⑦ on the subwoofer rear panel (in the AUX mode only).
- The microphone can be connected to the microphone jack ⑧ on the subwoofer rear panel.
- After using the MSS, mind to switch it off using the ON/OFF switch (③, OFF position) and unplug the power cord ④ from the socket.

Operation modes

BLUETOOTH Mode*

- To transfer the signal in this mode, establish the connection between the MSS and the audio source (see Fig. 5). Select the Bluetooth mode with the remote control or the VOLUME+/- ② buttons on the subwoofer front panel. In 2-3 seconds, the MSS will start searching for the Bluetooth audio source, a red and a blue LEDs will start blinking on the display ①.
- Select «Search for Bluetooth devices» on your signal source (phone, laptop, smartphone, etc.). The display of your signal source will show «SVEN»; select this device to establish the connection.
- If the connection is successful, the Search indication on the MSS goes out. If the devices haven't been connected within 2 minutes, the MSS enters the Standby mode (the blue LED blinks twice). To turn the MSS to the Search mode again, switch it off and then on**.
- When the data are being transferred from the connected device via Bluetooth, the blue LED on the display ① lights up for a short moment.
- When the Bluetooth connection is active, you can control the audio source player with the remote control using buttons ⑥, ⑦, and ⑧.

* To activate Bluetooth connection with some devices, entering «0000» code may be necessary.

** If the MSS is already in the list of Bluetooth devices on your audio source, you needn't activate the Search mode again. Just select the name of the MSS from the list on your audio source and the Connect option.

AUX Mode

- To switch to the AUX mode, press the AUX ④ button on the remote control or the «-» and «+» ② buttons on the front panel simultaneously, the MSS switched on. The display ① will show «AU» for a short moment.

ST-BY Mode

- To enter/exit this mode, press and hold down button ① on the RC. When the MSS is in the ST-BY mode, the display ① shows «- -».

MUTE Mode

- To enter the MUTE mode, press button ⑤ on the remote control. To exit the MUTE mode, press this button again.

Note. Due to the constant development of the software, the actual MSS operation may differ from that described in this manual. The most recent version of the manual is available at www.sven.fi.

Operation Manual

MS-350BL

6. TROUBLESHOOTING

Problem	Cause	Solution
The MSS does not turn on.	The MSS isn't connected to a mains outlet.	Check the connection.
	The power switch is off.	Turn on the switch.
No sound or the sound is too quiet.	Volume level is set at minimum value.	Adjust the volume control knob.
	Improperly connected audio source.	Connect the audio sources correctly.
Distortion of sound.	Large amplitude of the input signal.	Turn down the source volume and the MSS volume.
The remote control is not working.	The batteries are discharged.	Replace the batteries with new ones.

If none of the above methods can solve the problem, please seek professional advice at your nearest service center. Never attempt to repair the product yourself.

7. TECHNICAL SPECIFICATIONS

Parameter, measurement unit	Value
Output power (RMS), W subwoofer satellites	18 (10 + 2 × 4) 10 2 × 4
Frequency response, Hz subwoofer satellites	40 – 250 250 – 20,000
Speaker diameter, mm subwoofer satellites	Ø 105 full-range Ø 76
Bluetooth version	2.1 + EDR
Bluetooth operating range, m	up to 8
Power supply, V/Hz	~220/50
Dimensions, mm subwoofer satellites (one speaker)	165 × 233 × 215 84 × 179 × 90
Weight, kg	2.3

Notes:

- **Technical specifications given in this table are supplemental information and cannot give occasion to claims.**
- **Technical specifications and package contents are subject to change without notice due to the improvement of SVEN production.**

2.1 Multimedia Speaker System with Bluetooth

SVEN®
YOU WANT – WE CAN



Модель: **MS-350BL**

Импортер в России: ООО «СКАНДИТРЕЛ», 111024, РФ, г. Москва, ул. Авиамоторная, д. 65, стр. 1.
Уполномоченная организация в России: ООО «РТ-Ф», 105082, г. Москва, ул. Фридриха Энгельса, д. 75, стр. 5.
Условия гарантийного обслуживания смотрите в гарантийном талоне или на сайте **www.sven.fi**.
Гарантийный срок: 12 мес. Срок службы: 5 лет.
Производитель: «СВЕН ПТЕ. Лимитед», 176 Джу Чиат Роуд, № 02-02, Сингапур, 427447.
Произведено под контролем «Свен Скандинавия Лимитед», 48310, Финляндия, Котка, Котolahdentie, 15. Сделано в Китае.

Manufacturer: SVEN PTE. LTD, 176 Joo Chiat Road, № 02-02, Singapore, 427447. Produced under the control of Oy Sven Scandinavia Ltd. 15, Kotolahdentie, Kotka, Finland, 48310. Made in China.

© Registered Trademark of Oy SVEN Scandinavia Ltd. Finland.

MS – 350BL