

microlab

microlab

just listen



M-300  
User Manual

www.microlab.cn  
Microlab Electronics Co.,Ltd  
Made in China

Multimedia Speaker System

All other brand and product names are trademarks of their respective holders. Actual contents may differ slightly from those shown in print. All modifications and decisions are subjected to changes without any prior notice.

Prior to first use, please read the manual carefully

## Important Safety Instructions



### Caution:

To reduce the risk of electric shock, do not dismantle the product and do not expose the apparatus to rain or moisture. No user-serviceable parts inside. Refer servicing to qualified personnel only.

### Explanation of Graphical Symbols:

 The lightning flash within an equilateral triangle is intended to alert you to the presence of uninsulated dangerous voltage within the product's enclosure that may be of sufficient magnitude to constitute an electric shock to a person or persons.

 The exclamation point within an equilateral triangle is intended to alert you to the presence of important operating and maintenance (servicing) instructions in the literature accompanying the product.

### WARNINGS:

1. Read Instructions - All the safety and operating instructions must be read before the product is operated.
2. Retain Instructions - The safety and operating instructions should be kept with the product for future reference.
3. Heed warnings - All warnings on the product and in the operating instructions should be adhered to.
4. Follow instructions - All operating and users instructions should be followed.
5. Installation - Install in accordance with the manufacturer's instructions.
6. Power sources - This product should be operated only from the type of power source indicated by the marking adjacent to the power cord entry. If you are not sure of the type of power supply to your home, consult your product dealer or local power company.
7. Grounding or polarization - the product is not required to be grounded. Ensure the plug is fully inserted into the wall outlet or extension cord receptacle to prevent blade or pin exposure. Some versions of the product are equipped with a power cord fitted with a polarized alternating line plug (a plug having one blade wide than the other). This plug will fit onto the power outlet only one way. This is a safety feature. If you are unable to insert the plug fully into the outlet, try reversing the plug. If the plug should still fail to fit, contact your electrician to replace your obsolete outlet. Do not defeat the safety purpose of the polarized plug. When using an extension power-supply cord or a power-supply cord other than that supplied with the appliance, it should be fitted with the appropriate molded plugs and carry safety approval appropriate to the country of use.
8. Power cord protection - Power-supply cords should be routed so that they are not likely to be walked on, kinked or pinched by items placed on or against them, paying particular attention to cords from plugs, receptacles and the point where they exit from the appliance.
9. Overloading - Do not overload wall outlets, extension cords or multiple sockets, as this can result in a risk of fire or electric shock.
10. Ventilation - The product must be properly ventilated. Do not place the product on a bed, sofa, or other similar surface. Do not cover the product with any items such as tablecloths, newspapers, etc.
11. Heat - The product should be situated away from heat sources such as radiators, heat registers, stoves, or other products including amplifiers that produce heat. No naked flame sources, such as lighted candles, should be placed on the apparatus.
12. Water and moisture - To reduce the risk of fire or electric shock, do not expose the product to rain, dripping, splashing or excessive moisture such as in a sauna or bathroom. Do not use this product near water, for example, near a bathtub, washbowl, kitchen sink, laundry tub, in a wet basement, or near a swimming pool, or etc.
13. Object and Liquid Entry - Never push objects of any kind into this product through openings, as they may touch dangerous voltage points or short-circuit parts that could result in a fire or electric shock. Never spill liquid of any kind on the product. Do not place any object containing liquid on top of the product.
14. Cleaning - Unplug the product from the wall outlet before cleaning. The cabinet of the subwoofer may be cleaned by dusting with a dry cloth. If you wish to use an aerosol cleaning spray, do not spray directly on the cabinet; spray onto the cloth. Be careful not to damage the drive units.
15. Attachments - Do not use attachments not recommended by the product manufacturers, as they may cause hazards.

16. Accessories - Do not place this product on an unstable cart, stand, tripod, bracket or table. The product may fall, causing serious injury to a child or adult, and serious damage to the product. Use only with a cart, stand, tripod, bracket or table recommended by the manufacturer or sold with the product. Any mounting of the product should follow the manufacturers' instructions and should use a mounting accessory recommended by the manufacturer.
17. Moving the product - A product and cart combination should be moved with care. Quick stops, excessive force and uneven surfaces may cause the product and cart combination to overturn.
18. Un-use periods - The power cord of the device should be unplugged from the outlet during lightning storms or when the apparatus is left unused for a long period of time.
19. Servicing - Do not attempt to service this product yourself, as opening or removing covers may expose you to dangerous voltage or other hazards. Refer all servicing to qualified service personnel.
20. Please remove the power plug from the main power source or wall power source when not in use. When plugged in to a power source, the system is in standby mode, so the power is not entirely cut off.
21. Replacement parts - When replacement parts are required, ensure the service technician has used replacement parts specified by the manufacturer or have the same characteristics as the original part. Unauthorized substitutions may result in fire, electric shock or other hazards.
22. Mains fuses - For continued protection against fire hazard, use fuses only of the correct type and rating. The correct fuse specification for each voltage range is marked on the product.
23. Do not turn up the volume while listening to a section with very low level inputs or no audio signals. If you do, the speaker may be damaged when a peak level section is suddenly played.
24. The only means of completely disconnecting the product from the power supply is by removing the power cord from the wall outlet or the product. The wall outlet or the power cord entry to the product must remain freely accessible at all times while the product is in use.
25. Try to install the product near a wall socket or extension cord and shall be easily accessible.
26. The highest environmental temperature suitable for this product is 40°C.

## Illustrations

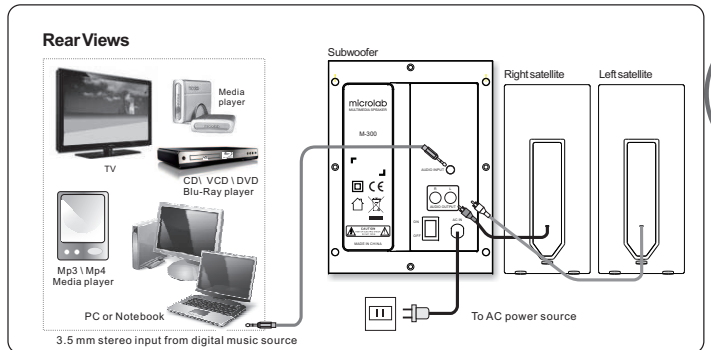
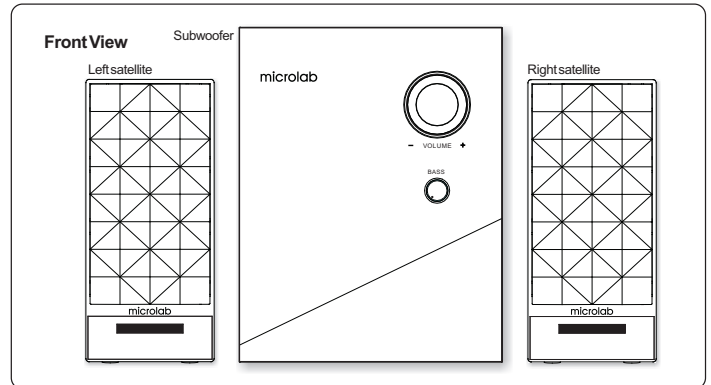

## Operation

### Connection:

1. Connect the left and right satellites to the subwoofer rear panel to its respective RCA jacks.
2. For analog source, connect the playback source (Media player, VCD, DVD, or CD player) to the 3.5mm stereo jack (AUDIO INPUT). The 3.5mm - 3.5mm stereo cable is provided with the package.
3. Please place the satellites on extreme sides in front of the listening position.
4. Connect the AC power cord to the power supply source.

EN  
3

## Introduction

Designed beautifully, this 2.1 speaker system lets you listen to most digital music in perfect harmony. Aesthetic in design, it fits into most room types such as bedroom, kitchen or even your studies. Featuring delicate woofer created for stronger bass and compact satellites for clear highs. Ideal for multimedia use, connects directly to any 3.5mm stereo interface. Subwoofer comes with bass reflex tunnel for deeper low frequency response. Satellite speakers with metal diamond texture. Easy to access master and bass volume controls.

### Features

- Quality 2.1 speaker system with built-in amplifier
- Satellite speakers with metal diamond texture
- Front panel volume controls
- Full audio spectrum performances, ideal for your favourite entertainment from Mp3, Mp4, CD/DVD movies and digital playbacks
- Specially designed woofer for bass and resolution
- Comes with 3.5mm stereo connection that connects to most media players and computers

### Package contents

M-300 subwoofer	1 pc
M-300 satellites	2 pcs
3.5mm - 3.5mm audio cable	1 pc
User manual	1 pc

EN  
4

## Operation

### Operation:

1. Turn on the AC power source and the speaker power from the rear panel power switch.
2. Activate the media player playback.
3. Adjust the volume on the media player, and speaker master volume to your preferred listening level.

## Technical Information

AMPLIFIER	
Total Power:	40 Watt RMS
Power distribution:	10 Watt x 2 + 20 Watt
Harmonic distortion:	< 0.3% 1 W 1 kHz
Frequency response:	30 Hz - 20 kHz
Signal/Noise ratio:	> 75 dB
Separation:	> 45 dB
Speakers	
Tweeter driver type:	2.5" x 2
Tweeter rated power:	10 Watt 6 ohm
Bass driver type:	5"
Bass rated power:	30 Watt 8 ohm
Interfaces	
Output:	2RCA
Input:	3.5mm stereo jack

Intentionally left blank

## Frequently Asked Questions (FAQ)

Frequently Asked Questions	Answers
Low volume output	Check the media source own volume level, adjust to about mid volume range and listen. Adjust speaker's own volume level to mid range and listen
No Sound	Check if the audio source is properly connected or media player's playback has started Ensure volume is correctly set Correct digital music format is used, e.g., Mp3
Static sound heard	Ensure playback track is of proper and higher bit rate, too much compression will increase noise level
What are the products supported?	Any playback devices such as PC, Media Players with 3.5mm stereo plug.
Sound is distorted	Check if the volume is at lower level and the Mp3 format is recorded at above 196 bitrate
Where to place this speaker	It is magnetically shielded so can be placed near LCD TV Monitor without any distortion
If the problem still exists, please contact the distributor or ask for professional service	

- The end -

© 2011 Microlab Electronics Co., Ltd All rights reserved.